

Flocculation reactor for improved flocculation at sludge thickening and dewatering

Flocculation of small sludge particles using the addition of polymers is a necessity for efficient sludge thickening and dewatering to take place.

By using flocculation reactors, which give residence times for flocculation to occur of 1-2 minutes during mixing, flocculation can occur completely before the polymer-sludge mixture enters the thickener/dewaterer.

The agitator is designed to eliminate possible ragging problems.

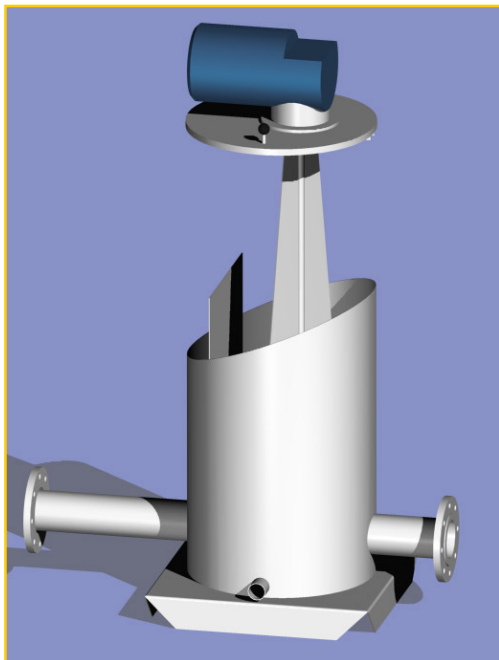

Siljan Allards supplies flocculation reactors, the capacities are selected to suit thickeners/dewaterers of different capacities; In the table below, the sizes and retention times of each flocculation reactor are shown.

Model	Diameter, m	Height, m	Retention time for the sludge-polymer mixture, in minutes.				
			SF 7	SF17	SF35	SF60	SF120 DUO
FR 0.2	0.64	1	1.8	0.76			
FR 0.6	0.8	1.25	3.6	1.5	0.72		
FR 1.0	0.94	1.5	5.7	2.4	1.15		
FR 1.7	1.27	2		6.0	2.9	1.5	1.5

Please contact us for further information.